

# 2018 AMPO Annual Conference

SEPTEMBER 24-28 | SAN ANTONIO, TEXAS



The Westin Riverwalk  
420 W Market Street | San Antonio

# Welcome to San Antonio!

Whether this is your first visit to the city, or you're returning as an old friend, we're happy to have you with us. There has been a lot going on in the area over the past several years, referred to as our Decade of Downtown. The 2018 AMPO Annual Conference brings you right to the heart of it.

Since 1963, the Alamo Area MPO has been performing transportation planning for South Central Texas, evolving in name and boundary over that half-century. Today the area is experiencing record growth, according to 2017 U.S. Census figures. Two counties in our study area, Comal and Kendall, were cited in the nation's Top 5 biggest percent population increases. Bexar County, home to San Antonio, was ranked 7th largest in numerical gain.

Like it is for so many of the communities represented by AMPO members, transportation planning and programming for our increasingly mobility-minded, technologically-connected public has never seemed as full of possibilities and challenges as it does now.

As you thumb through the pages of this program, you see the priorities of today's transportation planner represented in sessions dedicated to topics ranging from performance management and public engagement to mobility, safety, freight movement and smart city technology.

While there is so much to take advantage of throughout the conference, don't forget to look up - on Tuesday and Friday, the captivating San Antonio|The Saga is projected onto San Fernando Cathedral (show times at [www.mainplaza.org](http://www.mainplaza.org)) - and down, where exactly 300 Tricentennial-branded manhole covers have been installed on San Antonio streets as a reminder that this city is 300 years in the making and still going strong.

Hop on a river taxi, SWell Cycle, electric scooter or VIA VIVA bus route, and make your way up to one of our "Great Places in America" - the Pearl District on River North - or down to the World Heritage Designated Spanish Missions dotting the Mission Reach, and enjoy your stay in the Alamo City.

**Sincerely,**



**KEVIN WOLFF**

Chair, Transportation  
Policy Board, Bexar  
County Commissioner



**SID MARTINEZ**

Director, Alamo Area  
Metropolitan Planning  
Organization

# Thank you SPONSORS

## PLATINUM



[planningtools.transportation.org](http://planningtools.transportation.org)

## GOLD



## SILVER



## BRONZE



# 2018 AMPO AWARDS

WE ARE HONORED TO CONGRATULATE THE 2018 AWARD WINNERS!

National Award for Outstanding Overall Achievement for a TMA MPO  
**Northwestern Indiana Regional Planning Commission**

National Award for Outstanding Overall Achievement for a Non-TMA MPO  
**Northeast Arkansas Regional Transportation Planning Commission**

National Award for Excellence in MPO Coordination and Partnership  
**Memphis Urban Area MPO**

Honorable Mention: **Partnering for Performance New Hampshire**

National Award for Outstanding Elected Official Leadership  
**Mayor John Gayle, City of Valdosta, Georgia**

Honorable Mention: **Esteban Bovo, Jr., Chair, Miami-Dade TPO**

National Award for Excellence in MPO Coordination and Partnership  
**Memphis Urban Area MPO**

Honorable Mention: **Partnering for Performance New Hampshire**

National Award for Excellence in MPO Staff Achievement  
**Robert E. Griffiths, Metropolitan Washington Council of Governments**



**Ronald F. Kirby National Award for Outstanding Individual Leadership**

**Ronald Milone**

**METROPOLITAN WASHINGTON COG**

Ronald F. Kirby will be remembered as a leading expert in transportation planning and a key figure in the MPO community. The Ronald F. Kirby National Award for Outstanding Individual Leadership honors the contributions and advancements that he made. AMPO honors outstanding efforts in planning and leadership from an individual who has advanced or promoted the cause of planning in the public arena.



# Conference INFORMATION

## Evaluation Form

AMPO will email registrants a link for a conference evaluation survey. Your comments and suggestions are appreciated and will be helpful as we plan workshops, plenaries, and networking opportunities for future conferences.

The 2018 AMPO Annual Conference PowerPoint presentations will be posted on the AMPO website in November.



SAVE THE DATE!



## PLANNING TOOLS & TRAINING SYMPOSIUM

MAY 7-9, 2019 | MINNEAPOLIS

2019 AMPO  
Annual Conference

OCTOBER 21-25 | BALTIMORE, MD

2020 AMPO  
Annual Conference

OCTOBER 26-30 | MINNEAPOLIS, MN

The 2019 AMPO Annual Conference call for presentations will open in January. Visit [www.ampo.org](http://www.ampo.org) for more information.

# Conference HIGHLIGHTS

**MON**

MOBILE WORKSHOP:

## Welcome to San Antonio Walking Tour

The walking tour begins at the Westin Riverwalk and concludes at Yanaguana Garden, the first area to be redeveloped in historic Hemisfair.

**TUE**

## Wine on the Patio

The Palm (Hotel Contessa)

**WED**

## Member-led Breakout Sessions

**Room:** Villa (Ballroom Level)

A facilitator will lead each group in an open discussion of critical MPO issues and opportunities.

## Reception

The Briscoe Western Art Museum

**THU**

## Lunch & Keynote

**Room:** Navarro (Ballroom Level)

**FRI**

MOBILE WORKSHOP:

## Mission Reach Bike Tour

There is a fee for participating in the mobile workshops. Preregistration is required.

## Join the CONVERSATION

Join fellow conference attendees and AMPO staff for a Twitter dialogue and conference updates. Use the hashtag #AMPO2018.



Follow AMPO's Twitter account: [@Assoc\\_MPOs](https://twitter.com/Assoc_MPOs)



## Shailen P. Bhatt

**President and CEO of the Intelligent Transportation Society of America (ITS America)**



Shailen P. Bhatt is President and CEO of the Intelligent Transportation Society of America (ITS America), where he promotes policies that advance the development and deployment of intelligent transportation technologies throughout the United States.

Previously, Bhatt served as Executive Director for the Colorado Department of Transportation (CDOT), where he led the department in planning for and addressing Colorado's transportation needs. Bhatt oversaw 3,300 employees statewide and an annual budget of approximately \$1.4 billion, guiding an organization committed to becoming the best DOT in the country. During his tenure, CDOT launched the Road X program which is focused on deploying innovative technology solutions such as connected vehicles and teaming with the private sector to shape the future of transportation.

Prior, he was Cabinet Secretary for the Delaware Department of Transportation, where he managed nearly a billion dollar budget and 2,800 employees. During his tenure, he led the agency response to two hurricanes, introduced performance management to the agency, and reduced agency debt by 30% while delivering \$2 billion in infrastructure improvements. He was also responsible for the Delaware Transit Corporation and the DMV. Bhatt also served as an Associate Administrator at the Federal Highway Administration (FHWA).

Bhatt is a respected leader in the transportation field. He previously served on the American Association of State Highway Transportation Officials (AASHTO) Board of Directors and chairs the AASHTO Subcommittee on Transportation Systems Management and Operations (STSMO). He serves as the Chair of the Board of Directors for the National Operations Center of Excellence (NOCoE). In addition, Bhatt is a member of the World Economic Forum's (WEF) Global Agenda Council on the Future of Automotive and Personal Transport. Previously, he served as the Chair of the Executive Committee of the I-95 Corridor Coalition, Diamond State Port Corporation, Board of Directors, and is a former Commissioner for the Northeast Corridor Commission.

Bhatt graduated summa cum laude with a Bachelor of Arts in Economics from Western Kentucky University. He is married with a wife and two daughters.

# Conference AGENDA

## Monday AGENDA

SEP 24

5:30 - 8:00 p.m.

MOBILE WORKSHOP:

**Welcome to San Antonio Walking Tour** (There is a fee for participating in the mobile workshops. Preregistration is required.)

Meet in the lobby of the Westin Riverwalk

The walking tour begins at the Westin Riverwalk and concludes at Yanaguana Garden, the first area to be redeveloped in historic Hemisfair. Yanaguana has 4.1 acres of active play environment designed for all ages and abilities and historic homes that are being filled with new tenants, including a coffee shop, a paleteria, a brewery, and a café. It is just a small part of the total 37-acre development to come featuring even more park space, new retail, and new residences. Learn how transportation has played a key role in this redevelopment process and the importance of interagency coordination and collaboration.

**Andres Andujar**, CEO, Hemisfair Park Area Redevelopment Corporation

## Tuesday AGENDA

SEP 25

2:00 - 5:00 p.m. | **Registration**  
**Room:** Westin Riverwalk Lobby

12:00 - 5:00 p.m. | **Exhibits**  
**Room:** Navarro Pre-function (Ballroom Level)

8:00 a.m. - 2:00 p.m.

**VisionEval Peer Exchange** (Preregistration is required.)

**Room:** Villa (Ballroom Level)

The Federal Highway Administration and AASHTO will host a peer exchange for states and MPOs with an interest in the VisionEval suite of scenario planning tools. VisionEval

includes the Rapid Policy Assessment Tool (RPAT), Regional Scenario Planning Tool (RSPM), and GreenSTEP among others. The peer exchange is an opportunity for practitioners to learn more about how the VisionEval tools can enhance planning and policy development processes. At the peer exchange, state DOTs and MPOs will share their experiences applying VisionEval strategic and scenario planning tools. Federal Highway Administration and AASHTO will also share information on work-in-progress enhancements to the user interface, visualization, and new modules. For more information about the VisionEval tool, visit <http://visioneval.org/>.

**Brian Gregor**, OSA; **Matt Hardy**, AASHTO; **Kyung-Hwa Kim**, Atlanta Regional Commission; **Christopher O'Neill**, Capital District Transportation Committee; **Jeremy Raw**, Federal Highway Administration; **Ben Stabler**, RSG; **Tara Weidner**, Oregon DOT

9:00 a.m. - 12:00 p.m.

## Association of Texas Metropolitan Planning Organizations (TEMPO) Meeting

**Room:** Navarro A (Ballroom Level)

2:30 - 5:30 p.m.

## TPM Implementation (Preregistration is required.)

**Room:** Goraz (River Level)

This session will discuss Transportation Performance Management (TPM) Implementation. The Federal Highway Administration, Federal Transit Administration, and AMPO will lead the workshop along with MPOs who will help share best practices in TPM Implementation. TPM Implementation is a critical part of federal requirements, including MAP-21 and the FAST Act.

**Brandon Buckner**, **Corbin Davis**, **James Garland**, **Susanna Hughes-Reck**, and **Jeremy Raw**, Federal Highway Administration; **Rich Denbow**, Cambridge Systematics; **Matt Hardy**, AASHTO; **Michelle Scott**, Boston Region MPO; **Peter Smith**, Texas DOT; **Dwayne Weeks**, FTA

1:00 - 3:00 p.m.

## Technical Committee Meeting

**Room:** Zapata (Ballroom Level)

## Policy Committee Meeting

**Room:** Navarro B (Ballroom Level)

## TUESDAY

3:00 - 3:15 p.m. | **Break**

**Room:** Navarro Pre-function (Ballroom Level)

3:30 - 5:30 p.m.

### Business Meeting

**Room:** La Babia (Ballroom Level)

6:00 –  
8:00 p.m.

### Wine on the Patio

**The Palm** (Hotel Contessa)

The Hotel Contessa is one block from the Westin Riverwalk at 306 W. Market Street.

8:15 - 9:15 p.m.

### Public Involvement Working Group Meet and Greet

**Room:** TBD

The AMPO Public Involvement Working Group supports public involvement in metropolitan transportation planning that meets federal requirements and strengthens the delivery and stewardship of programs, projects, and the transportation system. It is open to anyone interested in joining since everyone communicates and works with the public no matter their role within their agencies. For more information or to join, contact Rachel Roper at rroper@ampo.org or Christopher Ryan at ryanc@browardmpo.org.

**Christopher Ryan**, Broward MPO; **Linda Alvarado-Vela**, Alamo Area MPO; **Amanda Wilson**, North Central Texas Council of Governments

## Wednesday AGENDA

SEP 26

7:00 a.m. - 5:00 p.m. | **Registration**

**ROOM:** Navarro Pre-function  
(Ballroom Level)

7:00 a.m. - 5:00 p.m. | **Exhibits**

**ROOM:** Navarro Pre-function  
(Ballroom Level)

7:30 - 8:45 a.m.

CONTINENTAL BREAKFAST WITH THE HOST SPOTLIGHT

## The Alamo Area MPO

**Room:** Navarro (Ballroom Level)

**Isidro “Sid” Martinez**, Alamo Area MPO Director; **Kevin Wolff**, Alamo Area MPO Transportation Policy Board Chair and Bexar County Commissioner; **Linda Alvarado-Vela**, Planning/Public Involvement Manager; **Cecilio Martinez**, GIS Manager; **Allison Blazosky**, Regional Transportation Planner

9:00 - 10:15 a.m.

## Member-led Breakout Sessions

**Room:** Villa or Zapata (Ballroom Level)

Participants will break into two groups based on MPO size. A facilitator will lead an open discussion of critical MPO issues and opportunities and record the main discussion points. This will provide an excellent forum to meet peer MPOs and learn about each other's planning challenges and successes.

**FACILITATORS:** **Regina Aris**, Baltimore Metropolitan Council; **Denise Bunnewith**, North Florida TPO; **Elisa Hoekwater**, Macatawa Area Coordinating Council; **Sooraz Patro**, Rapides Area Planning Commission; **Kofi Wakhisi**, Atlanta Regional Commission; **Amanda Wilson**, North Central Texas Council of Governments

10:30 - 11:45 a.m. | Breakouts

## Complete Streets (Part 1)

**Room:** Camino Real (Lobby Level)

Part 1 begins with one of Minnesota's first multi-jurisdictional ADA Transition Plans and the Corpus Christi MPO's regional Bicycle Mobility Plan.

**MODERATOR:** **Ron Chicka**, Duluth-Superior Metropolitan Interstate Council

**PRESENTERS:** **Charles Androsky**, Mankato/North Mankato Area Planning Organization; **Brigida Gonzalez**, Corpus Christi MPO

## Freight

**Room:** Villa (Ballroom Level)

Maintaining freight corridors is critical to the economy of regions and the nation. In this session, learn about the Broward MPO's challenges and opportunities in developing their Freight Transportation Advisory Committee that engages the regional freight community, the Florida MPO Advisory Council Freight Advisory Committee's development of a freight project prioritization program that helps strengthen the ability of Florida's MPOs to influence state and federal funding allocations, and the



## WEDNESDAY

Community Planning Association of Southwest Idaho's recently completed freight study that sought to address the transportation and land use needs of freight-dependent industries while balancing broader regional mobility and livability goals.

**MODERATOR:** **Andrew Canon**, Hidalgo County MPO

**PRESENTERS:** **Daniel Crotty**, Whitehouse Group; **Paul Flavien** and **Gregory Stuart**, Broward MPO; **Donald Ludlow**, CPCS; **Mary Ann Waldinger**, Community Planning Association of Southwest Idaho; **Michael Williamson**, Cambridge Systematics

### Land Use/Transportation Connection: Right-sizing Transportation Investments

**Room:** Zapata (Ballroom Level)

This session provides an update on national research into the "right-sizing" of transportation investments – defined as: repurposing, reusing or fundamentally resizing (either larger or smaller) an existing asset (or in some cases, plans for a future asset) for a newly understood economic function or purpose. Participants will learn about the roles and opportunities for MPO's in right-sizing initiatives and outcomes through in-depth case discussions of successful right-sizing outcomes facilitated by MPO's in Rochester, New York and Dallas, Texas.

**MODERATOR:** **Todd Ashby**, Des Moines Area MPO

**PRESENTERS:** **Kelsey Berry**, Gateway Planning; **Chandler Duncan**, Metro Analytics; **Kevin Feldt**, North Central Texas Council of Governments; **Jim Stack**, Genesee Transportation Council

12:00 - 1:30 p.m.

### Lunch & General Membership Meeting

**Room:** Navarro (Ballroom Level)

1:45 - 3:00 p.m. | Breakouts

### Public Involvement (Part 1)

**Room:** Camino Real (Lobby Level)

This two part session explores MPO practices in public involvement. In Part 1, learn from the Boston MPO's development of strategies for actively engaging the public in the development of a policy that identifies disparate impacts and disproportionate burdens on minority and low-income communities, the Alamo Area MPO's outreach targeted towards hard to reach populations, and the Broward MPO's building relationships through public engagement.

**MODERATOR: Craig Lyon**, Anchorage Metropolitan Area Transportation Solutions

**PRESENTERS: Linda Alvarado-Vela**, Alamo Area MPO; **Betsy Harvey**, Boston Region MPO; **Erica Lychak** and **Anthea Thomas**, Broward MPO

## Data Applications

**Room:** Villa (Ballroom Level)

Attendees will learn about the transportation impacts and lessons learned from the December 18, 2017 Amtrak 501 derailment near Dupont, Washington and how it helped validate and calibrate the Thurston Regional Planning Commission's dynamic traffic model, the latest technologies and datasets the Alamo Area MPO is working to plan for the transportation needs of the region, including their story maps and interactive mapping application, iMaps.

**MODERATOR: Nick Haven**, Tahoe MPO

**PRESENTERS: Mark Daily**, Thurston Regional Planning Commission; **Wendy Dodson** and **Cecilio Martinez**, Alamo Area MPO

## From Smart Cities to Smart State: Collaborating in Transportation Technology Projects

**Room:** Zapata (Ballroom Level)

This panel will discuss a new model for collaboration among stakeholders to advance emerging technologies to solve community mobility challenges. In a time where technologies are rapidly advancing and when technologies remain unproven, public agencies and industry can work together to pilot, learn, and scale new solutions to safely integrate them into the existing system.

**MODERATOR: Elaine Clegg**, City of Boise

**PRESENTERS: Tom Bamonte**, North Central Texas Council of Governments; **Roger Beall**, Texas DOT; **Kristie Chin**, University of Texas; **Art Reinhardt**, City of San Antonio; **Daniel Rudge**, Bryan/College Station MPO

**3:00 - 3:30 p.m. | Break with Exhibitors**

**Room:** Navarro Pre-function (Ballroom Level)

**3:30 - 5:30 p.m. | Breakouts**

## Connected and Automated Vehicles and Other Emerging Technologies

**Room:** Navarro B (Ballroom Level)

## WEDNESDAY

This panel seeks to provide the audience with an understanding of various approaches MPOs can take as emerging technologies are deployed. Attendees will hear about the USDOT's Connected Vehicle Pilot Deployment Program, explore current research in future mobility at the metropolitan level and its relation in both the short and long term to transportation system performance, and the results of a Florida DOT study that provides guidance to their MPOs and TPOs regarding the potential effects automated and connected vehicles may have on Long Range Transportation Plans. Participants will also get a "sneak peak" at a pending Federal Highway Administration guidebook designed to help planners use scenario planning methods to prepare for the potential impacts of connected and automated vehicles and learn about right-sized transit planning that integrates technology-enabled transportation services within a region.

**MODERATOR:** **Matt Hardy**, AASHTO

**PRESENTERS:** **Steven Gayle**, RSG; **Mark Reichert**, Florida DOT; **Hannah Twaddell**, ICF; **Govind Vadakpat**, Federal Highway Administration; **Mike Wallace**, Fehr and Peers

## Coordination and Collaboration

**Room:** Villa (Ballroom Level)

Attendees will learn about Vital Signs, an award-winning interactive performance monitoring website that was developed collaboratively by regional stakeholders in the Bay Area and the Hillsborough MPO's Vision Zero Action Plan that was implemented through collaboration of their MPO Policy Committee. Attendees will also hear an update from Federal Highway Administration on their National Economic Partnerships for Innovative Approaches to Multi-Jurisdictional Coordination.

**MODERATOR:** **Mary Ann Waldinger**, Community Planning Association of Southwest Idaho

**PRESENTERS:** **Beth Alden**, Hillsborough MPO; **James Garland**, Federal Highway Administration; **David Vautin**, Metropolitan Transportation Council and Association of Bay Area Governments

## Increasing Safety and Reliability through Transportation Incident Management Programs

**Room:** Zapata (Ballroom Level)

This session will highlight the work of four MPOs - from small and large metropolitan areas - who have taken on a leadership role in regional traffic incident management (TIM) programs. Through work with emergency responders from all stakeholder agencies, regions have benefitted from improved safety and reliability of the transportation system. Speakers will explain their approaches to TIM and the benefits they have found from taking on a leadership role in this program area.

**MODERATOR:** **DeLania Hardy**, AMPO

**PRESENTERS:** **Natalie Bettger**, North Central Texas Council of Governments; **Sarah Burnworth**, Metropolitan Transportation Commission; **Paul Carafides**, Delaware Valley Regional Planning Commission; **Tom Reinauer**, Southern Maine Planning and Development Commission



6:30 –

8:30 p.m.

## Reception

The Briscoe Western Art Museum  
210 W. Market Street

# Thursday AGENDA

SEP 27

7:00 a.m. - 5:00 p.m. | **Registration**

**Room:** Navarro Pre-function (Ballroom Level)

7:00 a.m. - 7:30 p.m. | **Exhibits**

**Room:** Navarro Pre-function (Ballroom Level)

7:30 - 8:30 a.m.

## Continental Breakfast with the Washington Update and Board of Directors Roundtable

**Room:** Hidalgo (Ballroom Level)

8:45 - 10:00 a.m.

## Reflections from the Past and Looking Forward

**Room:** Hidalgo (Ballroom Level)

**MODERATOR:** **DeLania Hardy**, Executive Director, AMPO

**PANELISTS:** **Steven Heminger**, Metropolitan Transportation Commission; **Richard Perrin**, T.Y. Lin International

10:15 - 11:15 a.m. | **Breakouts**

## SHRP2: Lessons Learned from Capacity Efforts and Next Steps

**Room:** Camino Real (Lobby Level)

SHRP2 solutions were created to make our roads safer and assist in reducing worker and driver exposure to dangerous conditions in construction zones, incident scenes, and congestion. State DOTs and MPOs participated heavily in the recent round of SHRP2. The Capacity focus area delivered several innovative tools, research, and processes to assist planning practitioners on a host of issues. This session walks through the products available from the SHRP2 Capacity focus area, along with lessons learned, and next steps for implementing these tools into the transportation planning process. While we will cover a host of topics, there will be a special focus on PlanWorks, EconWorks, TravelWorks and other tools available.

**MODERATOR: Amy Cummings**, Regional Transportation Commission of Washoe County

**PRESENTERS: James Garland**, Federal Highway Administration; **Matt Hardy**, AASHTO

## Technology with a Purpose: Planning for Real People and Real Problems

**Room:** Villa (Ballroom Level)

Technology is often considered the solution, when in reality it is a tool to address genuine community needs. This session organized by the Texas Innovation Alliance will highlight a variety of MPOs, cities, and transportation agencies who are actively collaborating with one another to address the state's most pressing mobility challenges. Key discussion topics will include applications of connected and automated vehicles, data management, and innovative public-private transit models.

**MODERATOR: Cheri Soileau**, Lake Charles MPO

**PRESENTERS: Jose de la Cruz, Art Reinhardt**, and **Paula Stallcup**, City of San Antonio; **Matt Prenzler** and **John Tiemann**, Via

## Return on Active Transportation and Practical Approaches to Transit Investment and Prioritization

**Room:** Zapata (Ballroom Level)

This session features the Utah Transit Authority's study on the economic impacts and benefits of active transportation to the region served by the Wasatch Front Regional Council and the Massachusetts Bay Area's collaboration in updating transit prioritization scoring to better reflect statewide workforce needs.

**MODERATOR: Becky Karasko**, North Front Range MPO

**PRESENTERS: Mike Brown** and **Chandler Duncan**, Metro Analytics; **Cecilia Viggiano**, EDR Group

11:30 a.m. - 1:00 p.m.



## Lunch & Keynote

**Room:** Navarro (Ballroom Level)

**SPEAKER: Shailen P. Bhatt**, President and CEO of the Intelligent Transportation Society of America (ITS America)



1:15 - 3:00 p.m. | Breakouts

## United States Department of Transportation Townhall

**Room:** Hidalgo (Ballroom Level)

The United States Department of Transportation will lead a discussion on high priority topics and emerging issues for MPOs. For each topic, the United States Department of Transportation will provide a presentation highlighting federal regulations and guidance.

**MODERATOR: Peter Buchwald**, St. Lucie TPO

**PRESENTERS: Brandon Buckner, Corbin Davis, James Garland, Heather Holsinger, Susanna Hughes Reck, Alexis Kuklenski, and Jeremy Raw**, Federal Highway Administration; **Dwayne Weeks**, Federal Transit Administration

## From Response to Recovery: How MPOs are Taking Steps to Prepare their Regions to Recover from Disaster

**Room:** Villa (Ballroom Level)

A significant portion of existing emergency planning revolves around response. However, the damage done to a transportation system can impact a region for weeks, months and even longer following an event. Recognizing this, the Federal Transit Administration partnered with Portland State University and experts from around the nation to develop a pilot training course on All-Hazards Transportation Recovery Planning that consists of strategies and recommendations on how effective planning and coordination can play a role in creating a sustainable transportation system that can respond to all-hazards. In the session, you will hear from the course developer and instructors as well as the MPOs that participated in the project. The session will encourage participant discussion with our panel.

**PRESENTERS: Peter Gies**, Broward MPO; **David Hutchinson**, Sarasota/Manatee MPO; **Colin Lentz**, Strafford MPO; **Jason Pavluchuk**, Pavluchuk & Associates; **Tom Reinauer**, Southern Maine Planning and Development Commission; **Sarah Siwek**, Sarah J. Siwek and Associates; **Cheri Soileau**, Lake Charles MPO; **Mark Wilkes**, Coastal Region MPO; **Johnny Wong**, Hillsborough MPO

## Complete Streets (Part 2)

**Room:** Zapata (Ballroom Level)

This two part session focuses on creating multimodal transportation options. Part 2 covers a free online app for creating Complete Streets that started as an initiative by the Utah Complete Streets Coalition, with seed funding from Utah's major MPO's, the Utah DOT, and Utah Transit Authority, and several MPOs and the Bryan/College Station MPO's efforts to identify opportunities to design and construct grade-separated active transportation facilities that serve as iconic community gateways while balancing the local mobility needs of pedestrians, bicyclists, and motorists on essential roadway corridors with the need to maintain or enhance regional traffic flow. Participants will also learn about the Transit Needs Index developed by the Houston-Galveston Area Council to assess the quantitative need to allocate scarce resources for new or existing transit sources and an array of methods and tools — including a new Federal Highway Administration guidebook — for incorporating multimodal connectivity analyses into the planning, programming, and decision making process.

**MODERATOR: Sooraz Patro**, Rapides Area Planning Commission

**PRESENTERS: Mike Brown**, Metro Analytics; **Christian Lentz**, Halff Associates; **Alan Rodenstein**, Houston-Galveston Area Council; **Daniel Rudge**, Bryan/College Station MPO; **Shawn Seager**, Mountainland MPO; **Hannah Twaddell**, ICF

**3:00 - 3:30 p.m. | Break with Exhibitors**

**Room:** Navarro Pre-function (Ballroom Level)

**3:30 - 5:30 p.m. | Breakouts**

## Implementation of Performance Metrics to Guide Better Decision Making

**Room:** Camino Real (Lobby Level)

This panel will discuss how scenario planning can be applied as a technique to facilitate a more responsive performance-based planning process – regardless of how the future unfolds – and the Chicago region's new program for distributing Surface Transportation Block Grant funds and insights on how to tie funding to the National Performance Management Measures. It will also cover the Alamo Area MPO's process to facilitate informed discussions around safety target-setting, the pilot project launched by Florida DOT and four Florida MPOs to see how performance measures could be used to educate and inform elected officials in Florida prior to Federal guidance being issued, and CAMPO's performance-based selection criteria that are used to select projects by the policy board for the 2019 TIP project call.



**MODERATOR: Chris Evilia**, Waco MPO

**PRESENTERS: Allison Blazosky**, Alamo Area MPO, **Ryan Collins**, Capital Area MPO (CAMPO); **Jesse Elam**, Chicago Metropolitan Agency for Planning; **Janae Futrell**, Consortium for Scenario Planning; **Carl Mikyska**, Florida MPO Advisory Council; **David Paine**, Freese and Nichols; **Mark Reichert**, Florida DOT

## Transportation System Management and Operations (TSMO)

**Room:** Villa (Ballroom Level)

This session explores MPO applications of TSMO. Panelists will share how regional TSMO can influence performance measures and data collection procedures to track progress toward achieving performance-based transportation planning operations objectives and best practices for implementing an operations focus in your organization, key benefits from embracing operations, and how to communicate your successes to the public. Presenters will also discuss advancements in vehicle occupancy verification that are being used by the North Central Texas Council of Governments and their application to performance measures, automated vehicles, and congestion pricing as well as four new techniques for crafting a congestion pricing program that can gain public “willingness to try.”

**MODERATOR: Ashby Johnson**, Capital Area MPO

**PRESENTERS: Mike Brown**, Metro Analytics; **Shawn Seager**, Mountainland MPO; **Patrick Son**, National Operations Center of Excellence; **Paul Steinberg**, Carma; **Ralph Volpe**, Federal Highway Administration Resource Center

## Public Involvement (Part 2)

**Room:** Zapata (Ballroom Level)

This two part session explores MPO practices in public involvement. In Part 2, hear best practices from the National Capital Region Transportation Planning Board for unpacking technical jargon and communicating to your audience in a clear way, and the Martin MPO for public outreach in their long-range plan that was designed to reach and teach everyone in Martin County. Participants will also be able to assist in developing a definitive checklist to prepare MPOs for the effective application of online public involvement to support planning projects.

**MODERATOR: Casey Covington**, Metroplan

**PRESENTERS: Beth Beltran**, Martin MPO; **Dave Biggs**, MetroQuest; **Maggie Doll**, Burns and McDonnell; **Abigail Zenner**, National Capital Region Transportation Planning Board

**6:00 - 7:30 p.m. | Happy Hour with Exhibitors**

**Room:** Navarro Pre-function (Ballroom Level)

# Friday AGENDA



SEP 28

7:00 - 9:00 a.m.

## MOBILE WORKSHOP: **Mission Reach Bike Tour**

(There is a fee for participating in the mobile workshops. Preregistration is required.)

Did you know that the Alamo is only one of five historic Spanish missions in San Antonio? Join us on a bike tour that will help you discover San Antonio's rich heritage and Spanish colonial architecture. The tour will begin at the Westin Riverwalk. Participants will walk together to the Main Plaza in front of the San Fernando Cathedral and then travel by bike on a low stress street to Confluence Park and then to Mission Concepcion, a World Heritage Site. From there, the group will take a VIA VIVA bus back to the Westin Riverwalk.

**7:30 - 9:00 a.m. | Continental Breakfast**  
**Room:** Navarro Pre-function

9:15 - 11:00 a.m. | Breakouts

## **MPO Operations, Roles, and Relevancy**

**Room:** Navarro B (Ballroom Level)

In this session, the Boston MPO will guide an audience discussion on how MPOs can manage data, interact with other agencies, and update their processes so that ongoing target setting, performance monitoring, project evaluation, and reporting becomes manageable, the Broward MPO will share an overview of its Transportation Planning Guidebook to detail how they are working directly with their member governments to develop consistent and impactful projects for its plans and programs, and the National Capital Region Transportation Planning Board will describe how their process evolved over the course of a few years to incorporate unfunded and visionary projects, programs, and policies for the first time into the long-range transportation plan. Attendees will also hear an overview from the research team completing a report for the Tampa Bay Area Regional Transit Authority focusing on the preferred framework for improving regional transportation decision-making and coordination in the multi-county Tampa Bay area.

**MODERATOR: Saleem Salameh**, KYOVA Interstate Planning Commission

**PRESENTERS: Lyn Erickson**, National Capital Region Transportation Planning Board; **Peter Gies**, Broward MPO; **Jeff Kramer**, Center for Urban Transportation Research; **Scott Lane**, Stantec; **Michelle Scott**, Boston Region MPO; **Nicholas Torres**, Whitehouse Group

## Let's Talk Resilience: Integrating Resilience into the Planning Process

**Room:** Villa (Ballroom Level)

The impacts of extreme weather events are one of the hazards that threaten our nation's transportation systems and the long-term investments that Federal, state, and local governments have made in transportation infrastructure. While conducting assessments of infrastructure vulnerability and risk to various natural and human-induced threats is becoming more common, many State DOTs and MPOs are just beginning to consider how to integrate these resilience considerations into the transportation planning process and core planning documents. During this session, the Federal Highway Administration will provide an overview of approaches to integrating climate resilience into the planning process and ongoing Federal Highway Administration efforts and guidance to facilitate integration into the planning process, as well as linkages to asset management, project design, and operations and maintenance activities. Representatives from three MPOs that are participating in the Federal Highway Administration's 2018-2020 Resilience and Durability Pilot Program will discuss their projects and overall approach to resilience.

**MODERATOR:** **Corey Hull**, Valdosta-Lowndes MPO

**PRESENTERS:** **Beth Alden**, Hillsborough MPO; **Heather Holsinger**, Federal Highway Administration; **Tom Jacobs**, Mid-America Regional Council; **Kristine Ronneberg**, Houston-Galveston Area Council

An aerial photograph of a city skyline at sunset. The sky is filled with soft, golden light and scattered clouds. The city buildings are illuminated with warm lights, and the water in the foreground reflects the city lights. The text is overlaid on the image in a clean, white font.

Thank you for attending the  
**2018 AMPO**  
**Annual Conference!**

We look forward to seeing you next year,  
**Oct. 21-25 in Baltimore!**

# AMPO BOARD & STAFF

## EXECUTIVE BOARD MEMBERS

### Craig Lyon

#### President

Coordinator, Anchorage  
Metropolitan Area Transportation  
Solutions  
*Anchorage, AK*

### Ashby Johnson

#### Vice President

Executive Director,  
Capital Area Metropolitan  
Planning Organization  
*Austin, TX*

## BOARD MEMBERS

### R. Todd Ashby, AICP

Executive Director,  
Des Moines Area Metropolitan  
Planning Organization  
*Des Moines, IA*

### Ron Chicka

Director, Duluth-Superior  
Metropolitan Interstate Council  
*Duluth, MN*

### Todd Lang

Director of Transportation  
Planning, Baltimore Metropolitan  
Council  
*Baltimore, MD*

### Hon. Elaine Clegg

Councilmember, City of Boise  
*Boise, ID*

### David Wessel

Manager, Flagstaff MPO  
*Flagstaff, AZ*

### Amy Cummings, AICP, LEED AP

Director of Planning Services,  
Regional Transportation  
Commission of Washoe County  
*Reno, NV.*

### Gregory Stuart

Executive Director, Broward  
Metropolitan Planning Organization  
(Southeast Florida)  
*Fort Lauderdale, FL*

## AMPO STAFF

### DeLania Hardy

#### Executive Director

[dhardy@ampo.org](mailto:dhardy@ampo.org)

### Levon Boyagian

#### Policy Consultant

[lboyagian@ampo.org](mailto:lboyagian@ampo.org)

### Bill Keyrouze

#### Technical Programs Director

[bkeyrouze@ampo.org](mailto:bkeyrouze@ampo.org)

### Rachel Roper

#### Technical Programs Manager

[rroper@ampo.org](mailto:rroper@ampo.org)

Thank you to our dedicated and hard-working  
committee members and host volunteers!

# WESTIN Floor Plan

## Ballroom LEVEL

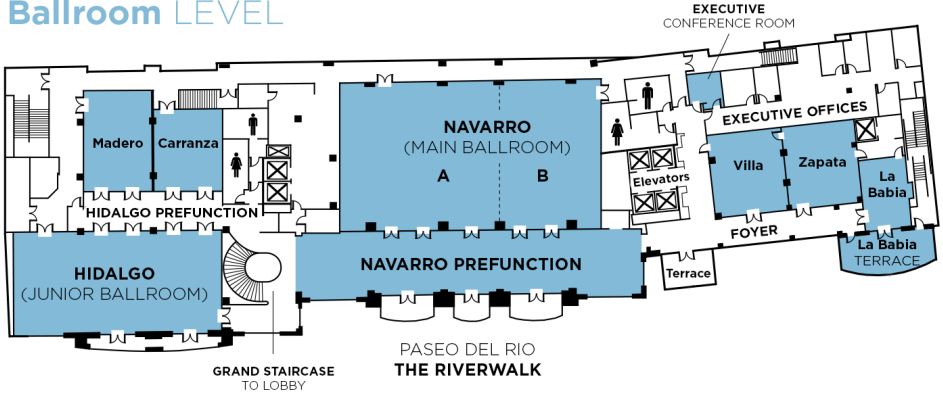

## Lobby LEVEL

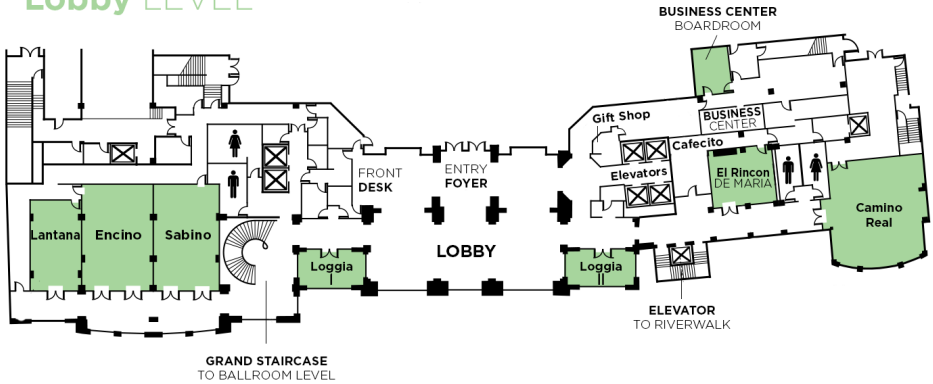

## River LEVEL

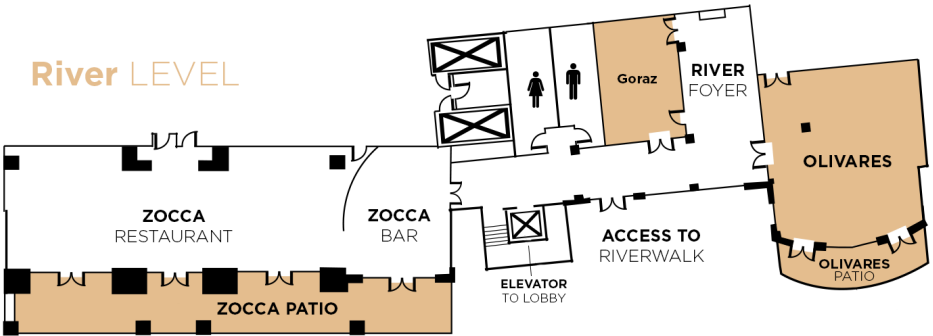



**Association of Metropolitan  
Planning Organizations**

444 North Capitol Street, NW

Suite 532, Washington, D.C. 20001

202.624.3680 | [www.ampo.org](http://www.ampo.org)